

Professional Office Space

359 Main Street, Grand Junction, CO 81505

For Lease



- 4,850 SF - 10+ Offices
- Wells Fargo Bank Annex
- Beautiful Downtown Ambiance
- Plenty of Off-Street Parking
- Lease @ \$12/sf/yr Full Svc

2ND FLOOR - MAIN STREET

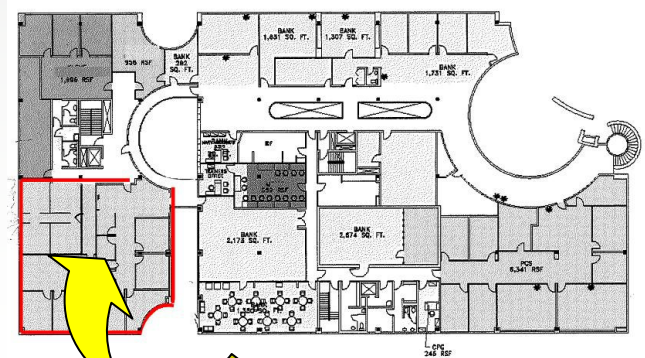

Second Floor Square
SCALE: 1/4" = 30'

AVAILABLE UNITS

Wells Fargo Bank, N.A.
Grand Junction Downtown

10/12/02
Dale Beede
10/12/02
Date:
Proj: #
File: 120702-2.dwg
Sheet Title
Second Floor
Square Footage
Sheet No. of

Contact Information :

Dale Beede CCIM
dbeede@cbcworldwide.com
Phone : (970) 244-6615

All information herein is from sources deemed reliable, however, broker makes no warranties, express or implied as to the accuracy of the information or to the suitability of this property for the investor.



PRIME PROPERTIES, LLC

www.grandjunctioncommercial.com

www.CBCWorldwide.com

550 Patterson Rd., Suite B,
Grand Junction, CO 81506
(970) 243-7375