

# Professional Offices

2808 North Avenue, Grand Junction, CO 81501

For Lease



WELLS  
FARGO

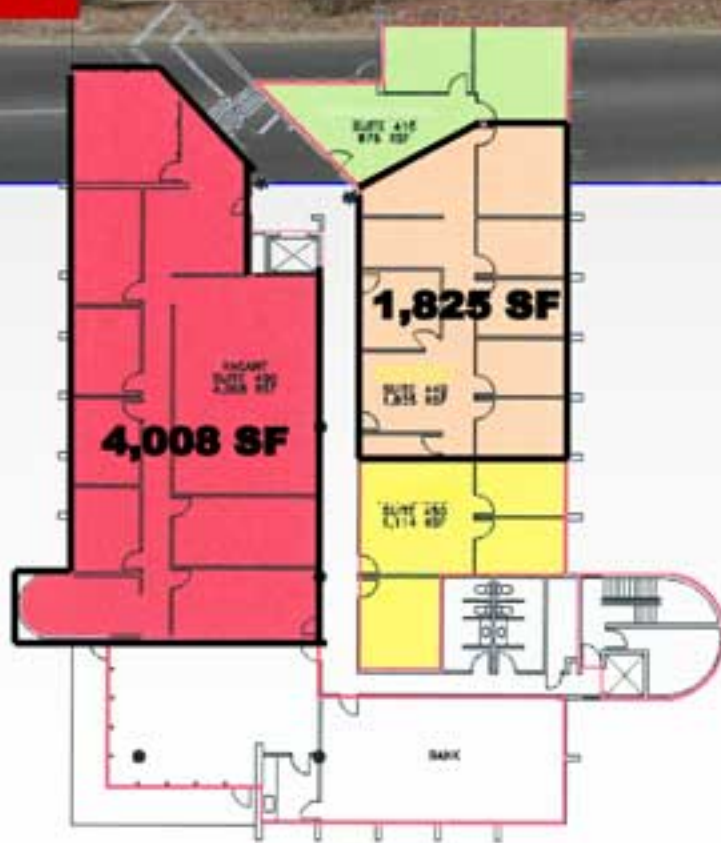

① Fourth Floor Square Footage

SCALE 1/16"=1'-0"

- Professional Office Space
- 4,000 SF & 1,825 SF - 4th Floor
- Handicapped Elevator Access
- North Avenue Business Corridor
- TI's Negotiable for Three Year + Terms
- Two Year Minimum Lease
- \$10 - \$14/sf/yr Gross Lease

## Contact Information :

Dale Beede, CCIM  
mfoster@cbcworldwide.com  
Phone : (970) 244-6615

All information herein is from sources deemed reliable, however, broker makes no warranties, express or implied as to the accuracy of the information or to the suitability of this property for the investor.



PRIME PROPERTIES, LLC

[www.grandjunctioncommercial.com](http://www.grandjunctioncommercial.com)

[www.CBCWorldwide.com](http://www.CBCWorldwide.com)

© 2008 Coldwell Banker Real Estate LLC. Coldwell Banker Commercial ® is a registered trademark licensed to Coldwell Banker Real Estate LLC. An Equal Opportunity Company. Each Office Is Independently Owned And Operated

550 Patterson Rd., Suite B,  
Grand Junction, CO 81506  
(970) 243-7375